

PUMP/PURGE PORT
1/4" SWAGELOK

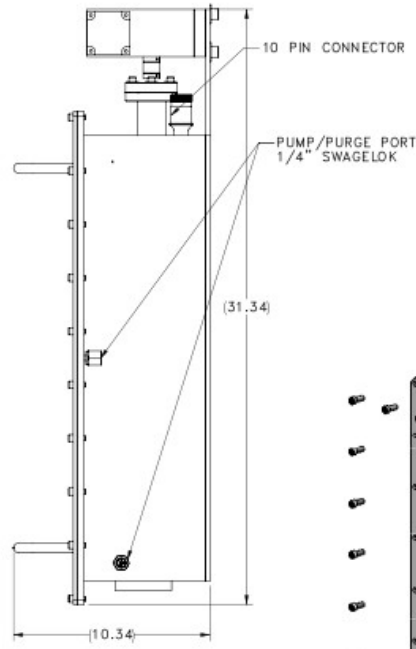

ENTRY/EXIT PORT
SWAGELOK

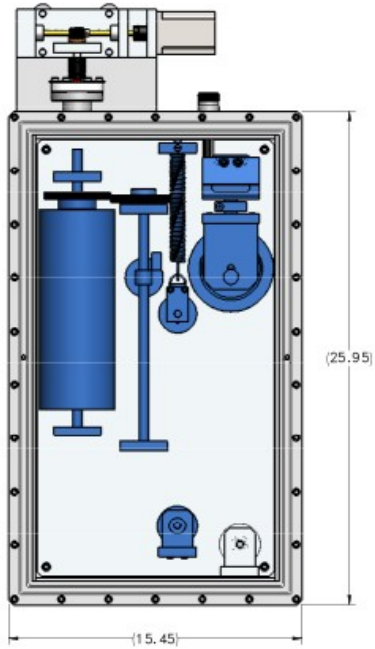
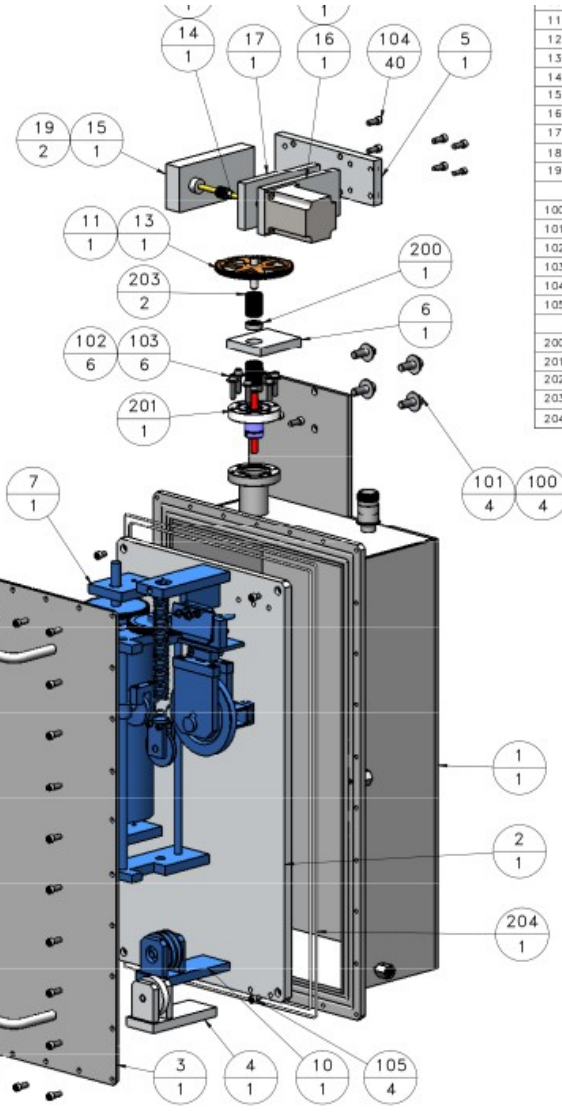
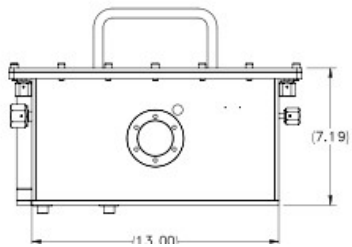

11	EXISTING COMP. / 3/8" SHAFT
12	EXISTING COMP. / WORM GEAR 1/4" SHAFT
13	G1039 EXISTING COMP. / BOSTON GEAR
14	GLUH EXISTING COMP. / BOSTON WORM GEAR
15	EXISTING COMP. / GEAR BRACKET WITH BEARING 1" THK.
16	EXISTING COMP. / GEAR BRACKET NO BEARING 1/4" THK.
17	EXISTING COMP. / GEAR BRACKET WITH BEARING 1/4" THK.
18	KML062F13 EXISTING COMP. / MOTOR SUPERIOR ELECTRIC
19	EXISTING COMP. / SPACER SHIM 1/4" SHAFT TO 3/8"
100	WASHER, PLAIN TYPE B, SERIES R, 3/8
101	SCREW, SOC HD CAP, 3/8-16 X 1.00
102	WASHER, PLAIN TYPE A, SERIES N, 1/4
103	SCREW, SOC HD CAP, 1/4-20 X 1.00 FULL THREAD
104	SCREW, SOC HD CAP, 1/4-20UNC-0.63
105	SCREW, SOC HD CAP, 1/4-20 X 1.13
200	6384K54 BEARING, STEEL DOUBLE SHIELDED - 7/8 O.D. X 9/32
201	FERROFLUIDIC FEEDTHRU 3/8" SHAFT
202	1/4" COUPLER
203	3/8" COUPLER
204	O-RINGS - CUSTOM ORDER - 3/32" CROSS SECTION

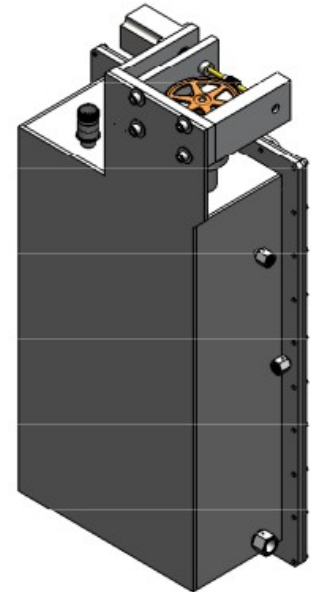



McMASTER-CARR

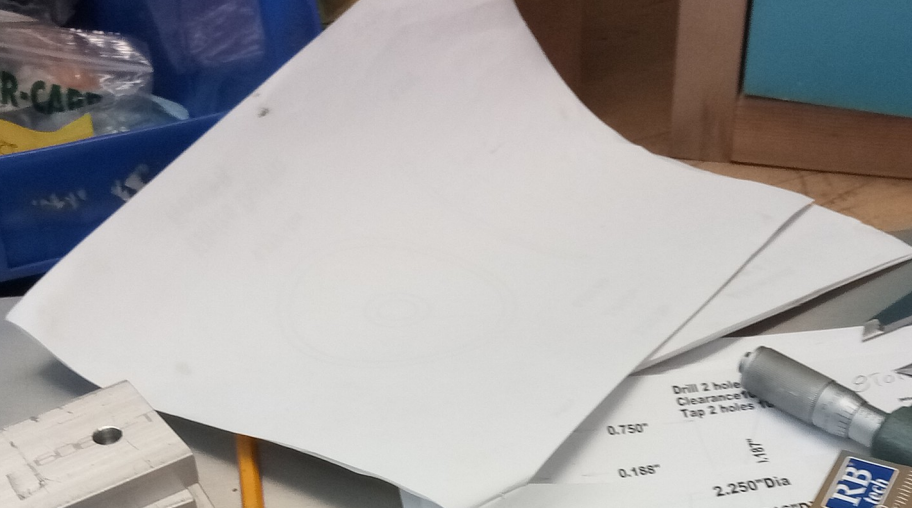
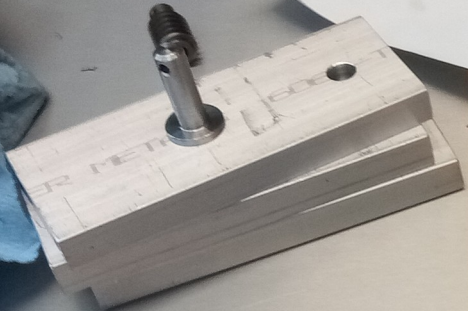
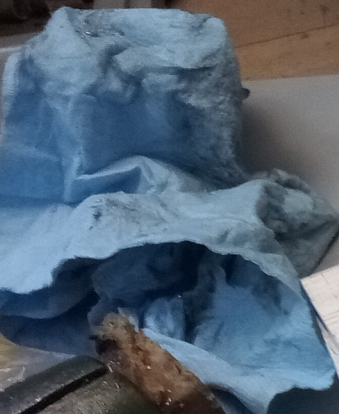

Drill 2 hole
Clearance fit
Tap 2 holes

0.750"

0.188"

1.80"

2.250" Dia

2.016"

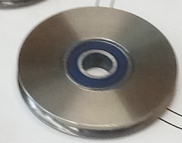

0.375" Dia ±
White Delrin
Need 4

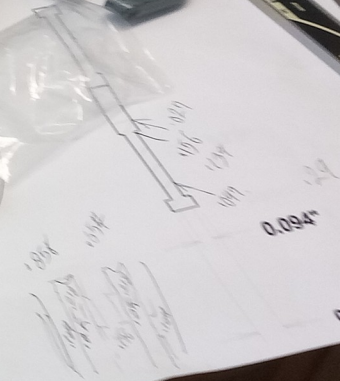

WORKING DAYS

TODO list

- Complete machining of back plane for temporary motor mount (1 plate + 3 brackets)
- Drill holes in back planes for mounting motor plate
- Complete assembly of unit 1 :
 - Pulley at bottom of spring (press bearings into place)
 - Assemble encoder pulley unit (press bearings into place)
 - Gear and drive shaft for spool mechanism (need assembly)
 - Assemble temporary motor drive (worm gear, couplings)
- Unit 1 initial drive tests with SNO+ controller
- Test opto isolator board – measure noise with and without
- Complete purchase orders for encoders, loadcells and 4 motors plus missing gears for remaining 3 units
- Assemble other units