

SEM Meeting

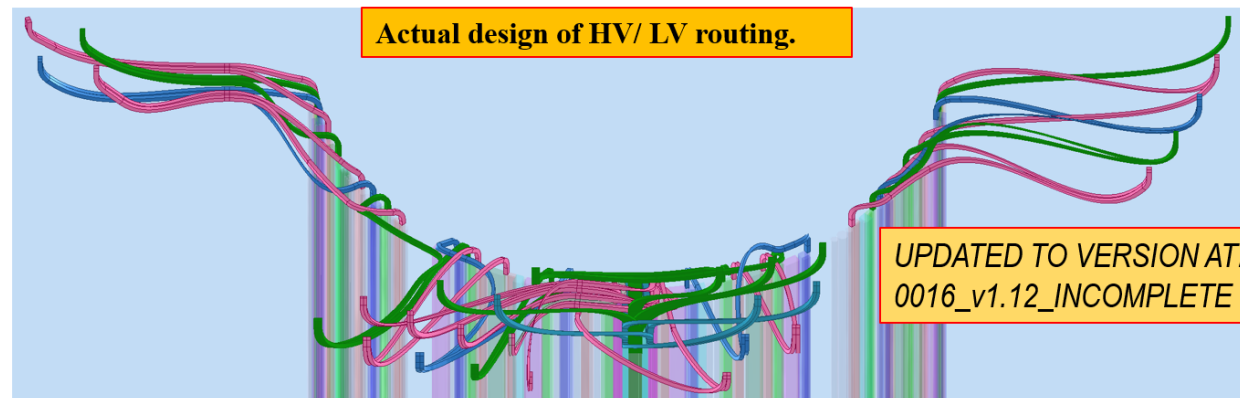

INFN-LNF
F. Rosatelli
09/06/2021

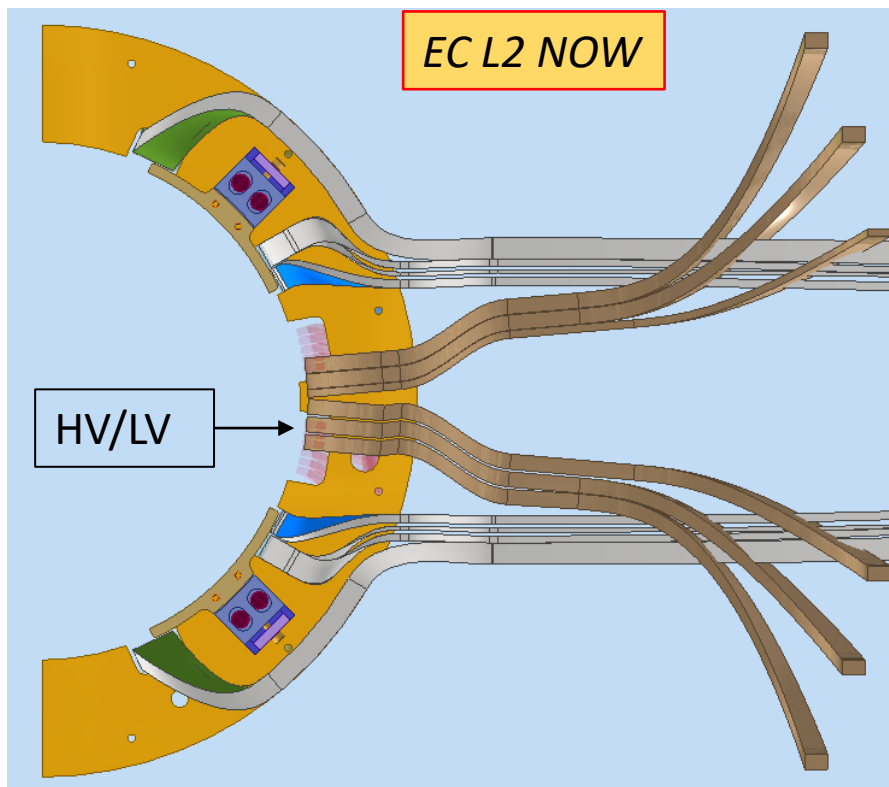

UPDATED TO VERSION AT2-IP-ES-0016_v1.12_INCOMPLETE (Matthias)

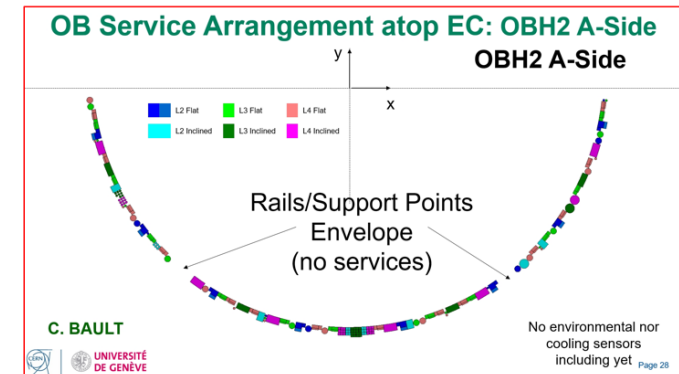

Activities:

- Update the Layer 2 routing in End caps (WIP). Waiting news from ATLAS collaboration to update Layer 3 and Layer 4.
- Align Outer Barrel routing with the last services mapping. There will be small changes.
- Preliminary disposition in data Feedthroughs to check the routing outside the PP1.

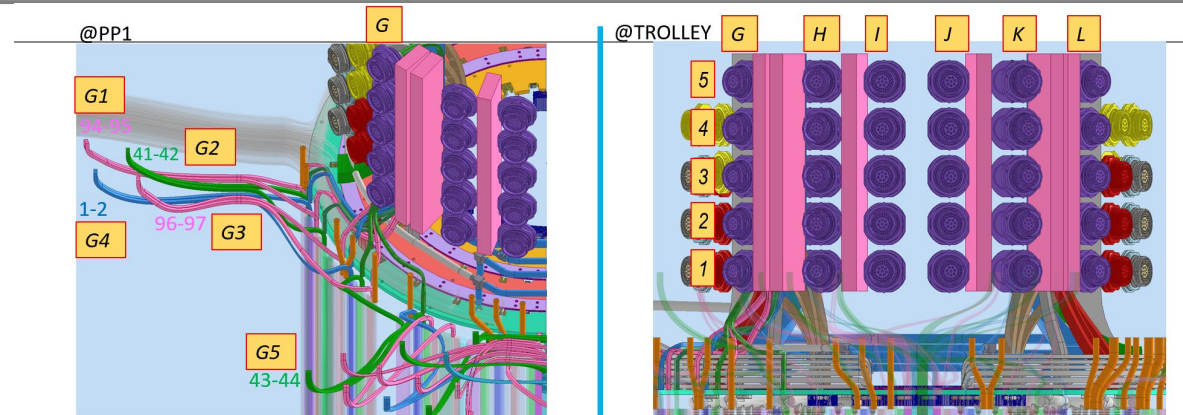
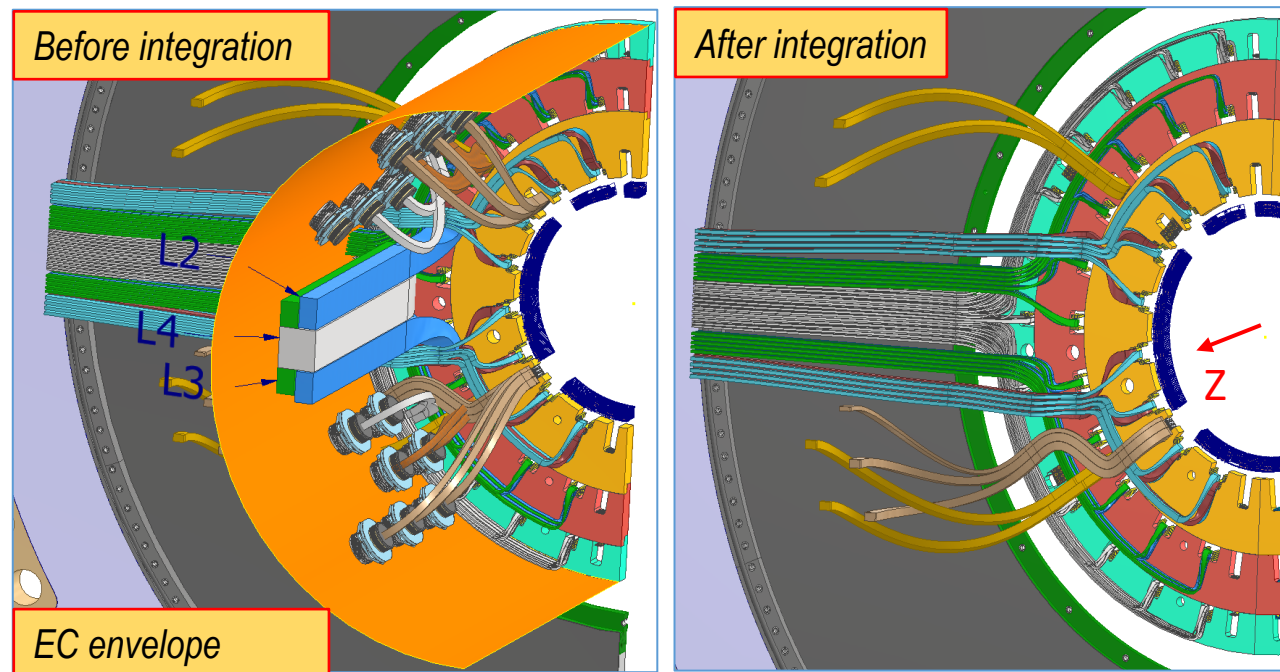

Bundle number	Destination @PP1	Layer	length1 [mm]	length2[mm]	routing @trolley				
					Connector	L1	L2	Δ1	Δ2
94-95	PP1-OS-A5-R4-P1	4	384	402	G1	372	330	12	72
41-42	PP1-OS-A5-R3-P1	3	333	356	G2	491,5	313	-158,5	43
96-97	PP1-OS-A5-R3-P2	4	377	466	G3	443	461	-66	5
1-2	PP1-OS-A5-R4-P2	2	378	476	G4	378	409	0	67
43-44	PP1-OS-A6-R4-P1	3	498	383	G5	495	575	3	-192

• Uniform cables at same length (ex. 600 mm)

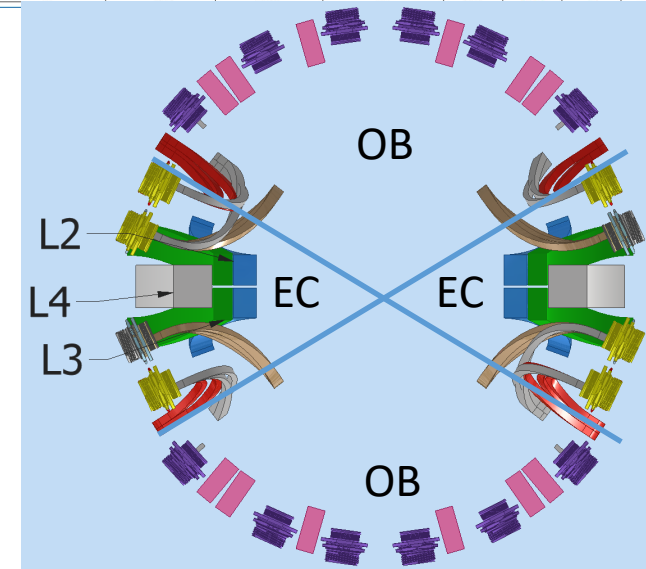

Activities:

- Preliminary study of data link and power cables disposition on trolley. This respecting the integration sequence and envelope assigned.
- Verify if the layout on trolley it's compatible with the length of the cables in the detector (WIP).

1:1 SCALE FEEDTHROUGH OS

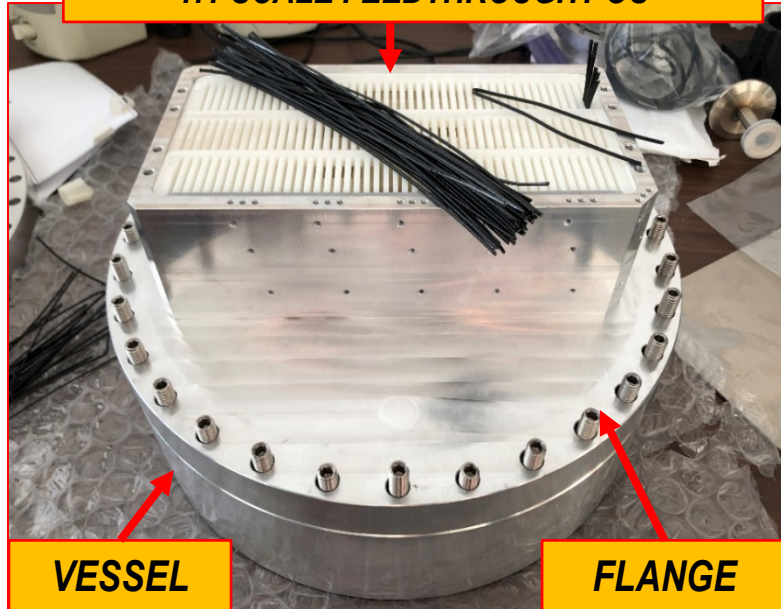

PREPARATION OF COMBS



FEEDTHROUGH WITH DATA LINK



Activities:

- Full scale Outer system feedthrough ready for filling process. Data link 2484.
- Test the behaviour of different compounds for filling.

Prototype tested

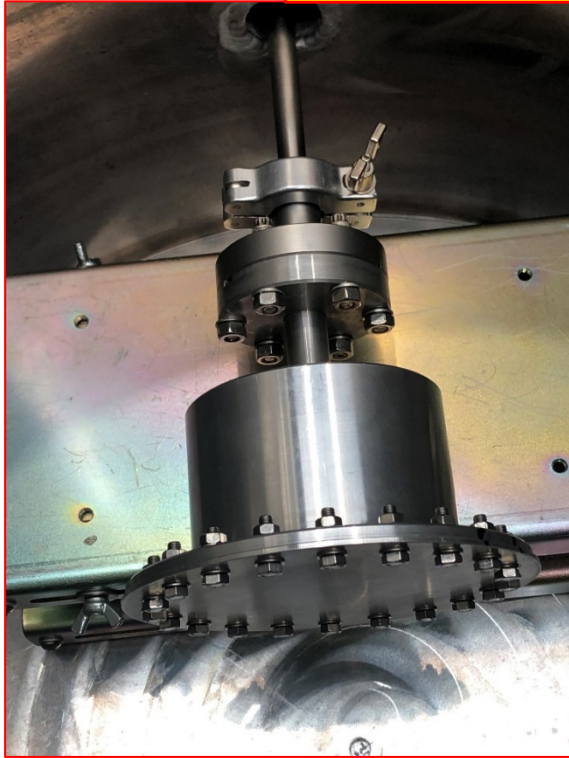

New prototype

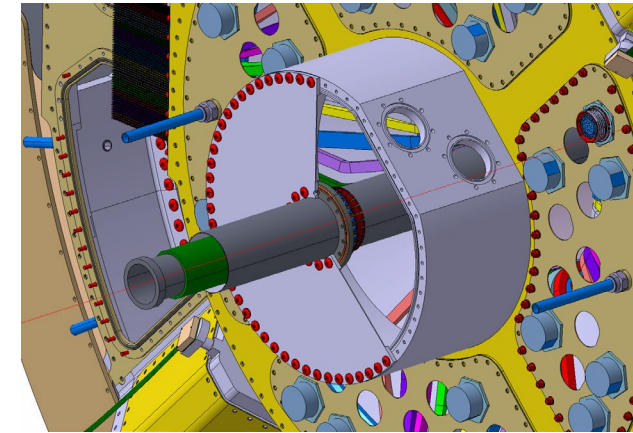
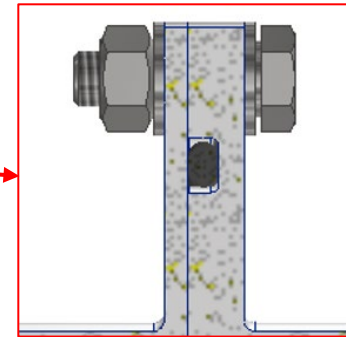
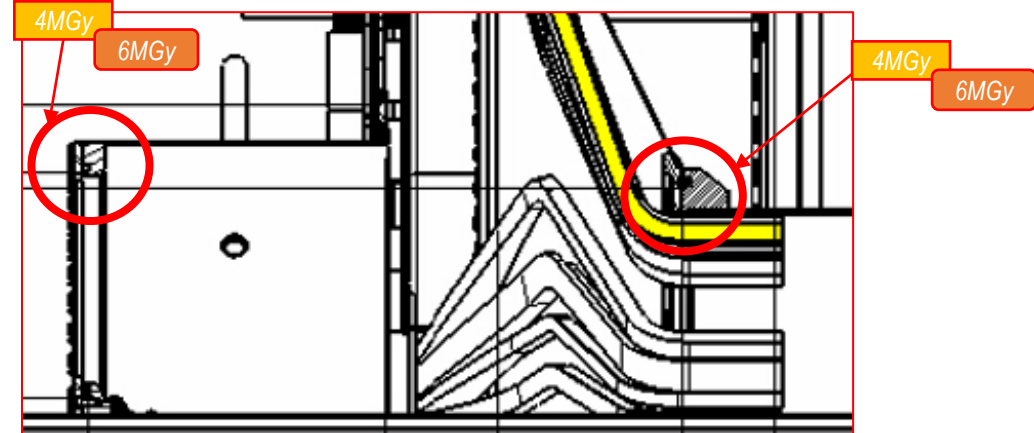
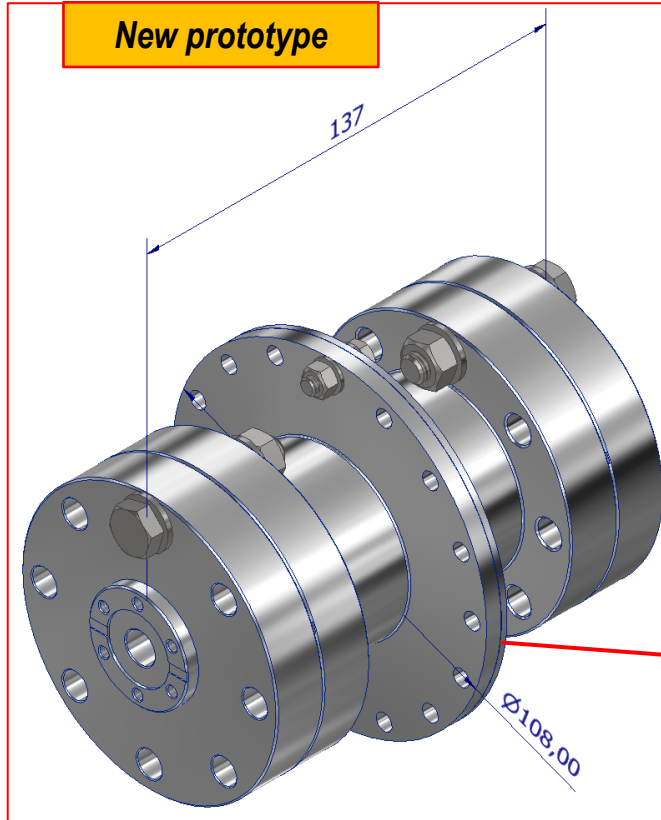

Activities:

- O-ring Leak check test performed. Radiation dose 3,5 MGy.
- Design a new prototype to test a new batch of compressed O-ring (Shieldseal® 663), up to 6 MGy.

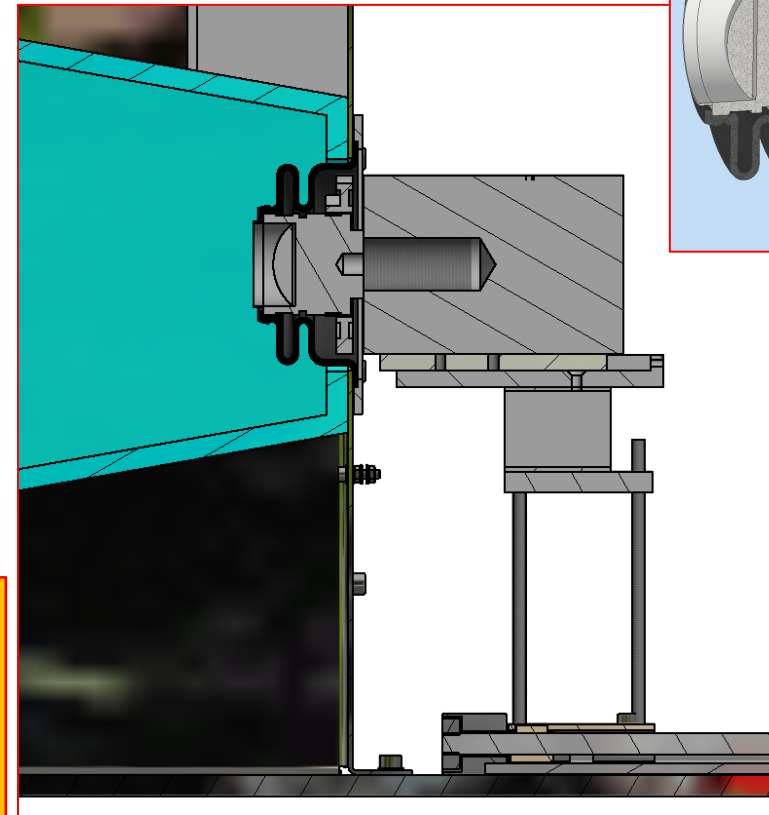
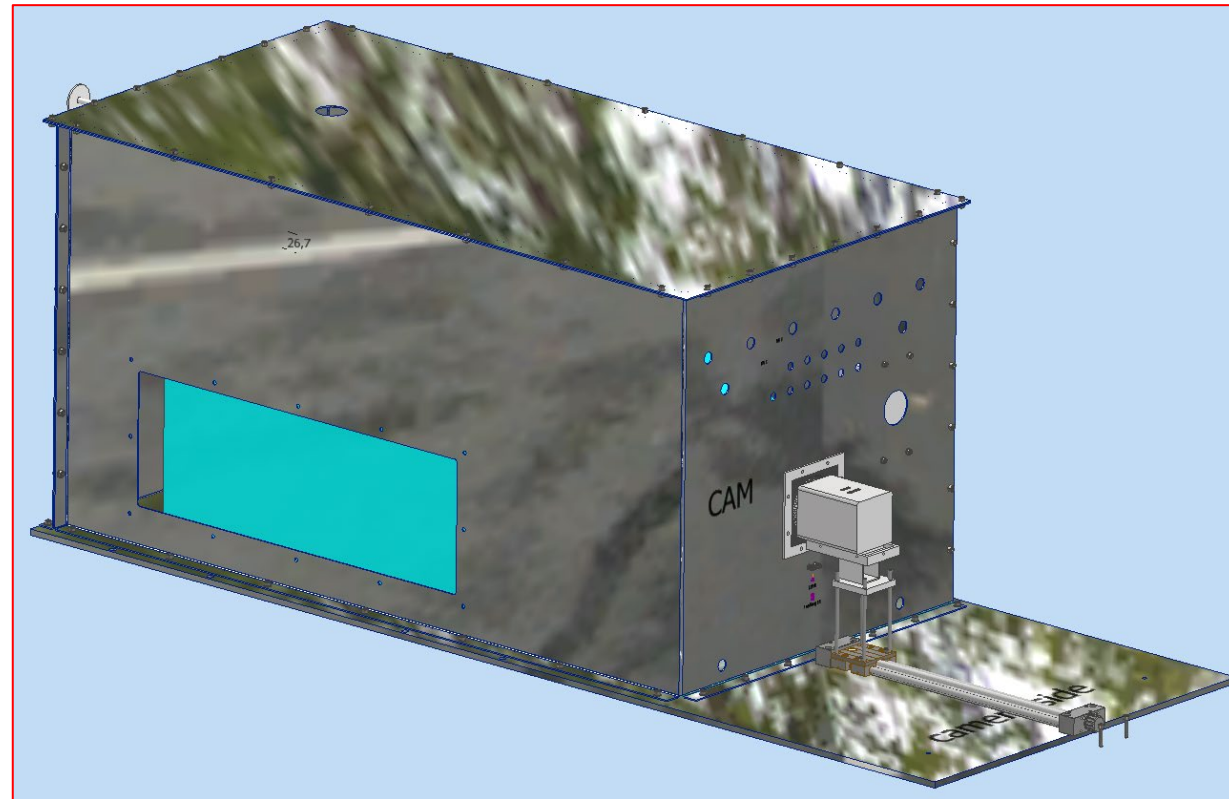

Activities:

- New bellow for camera.
- Regulation system for camera lens (WIP).
- Support to the experiment.