

LIME @ LNGS

UNDERGROUND

BOX TOP VIEW

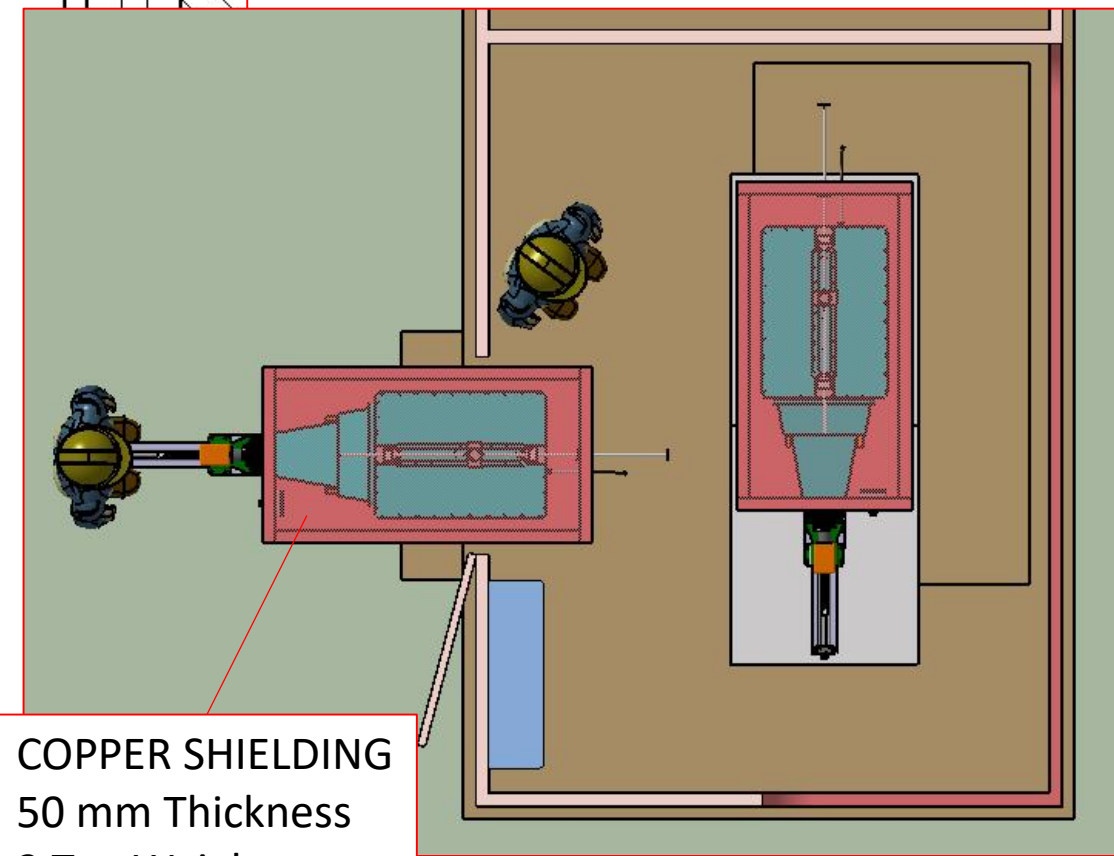
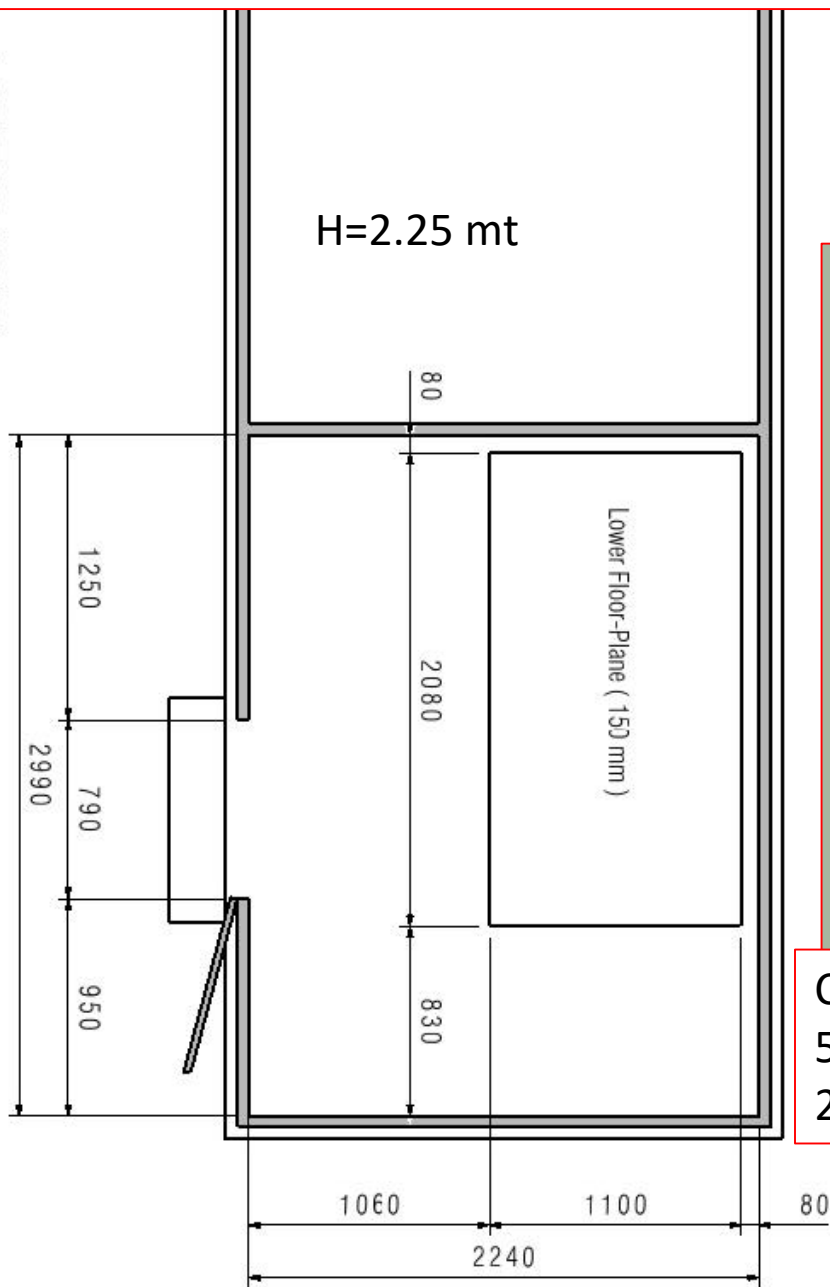

COPPER SHIELDING
50 mm Thickness
2 Ton Weight

LIME @ LNGS (UNDERGROUND)
- 3d VIEW

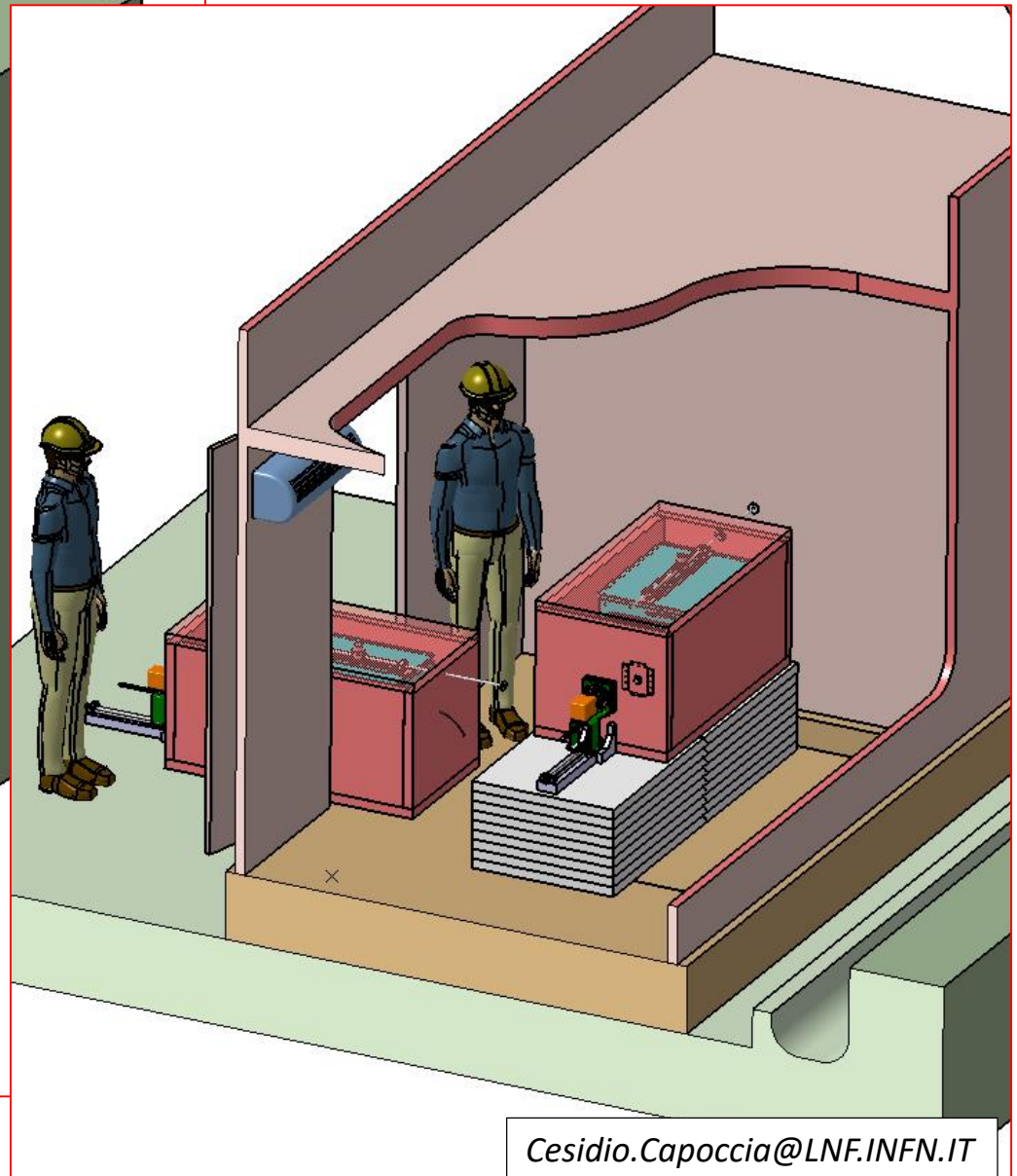
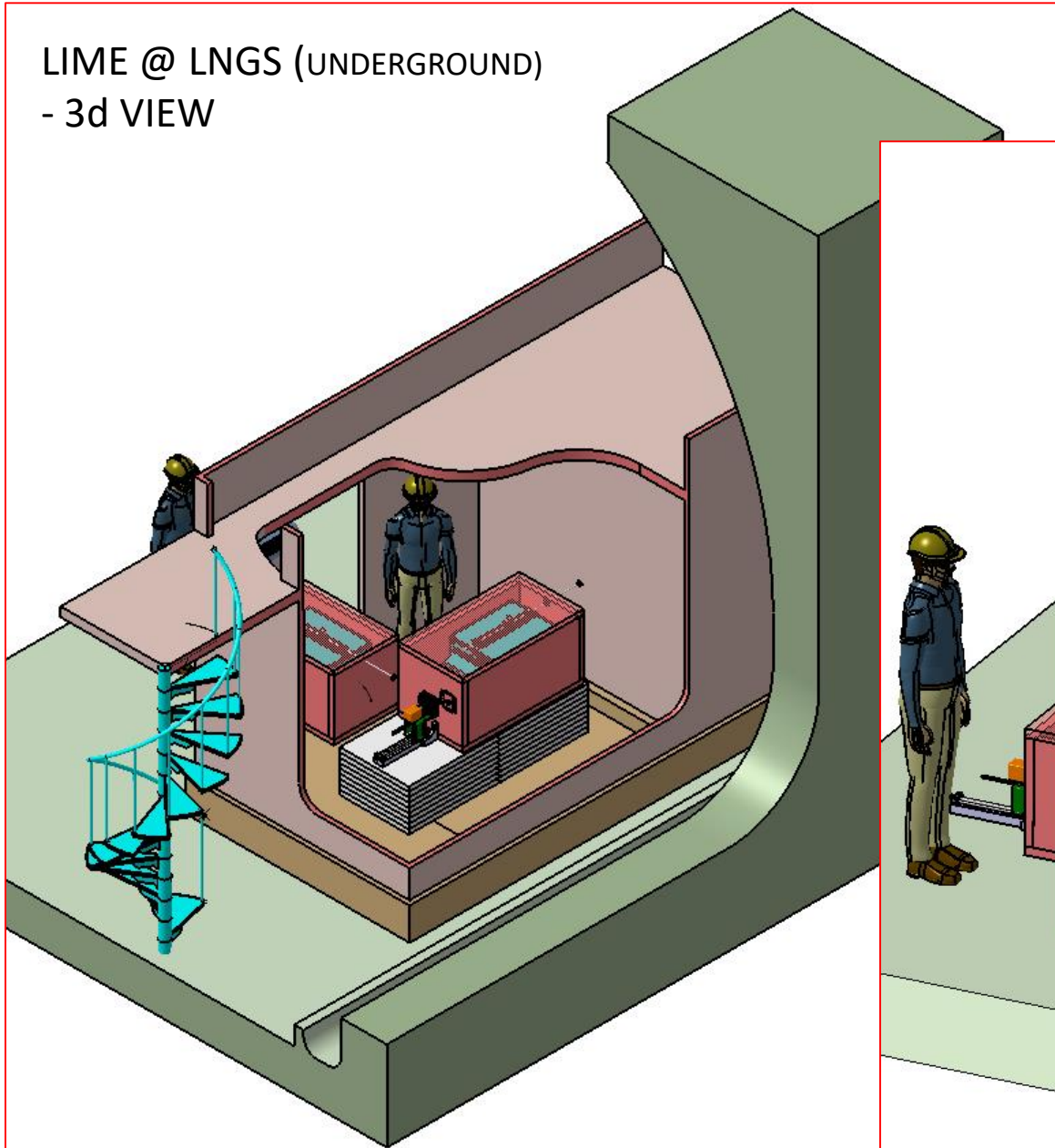

... WITH UPPER FLOOR...
*Used as Control & Service Room
(Gas System – Storage...)*
... AND GROUND FLOOR...
*Used as Clean-Room
(with SEPA filtered Air pumping)*

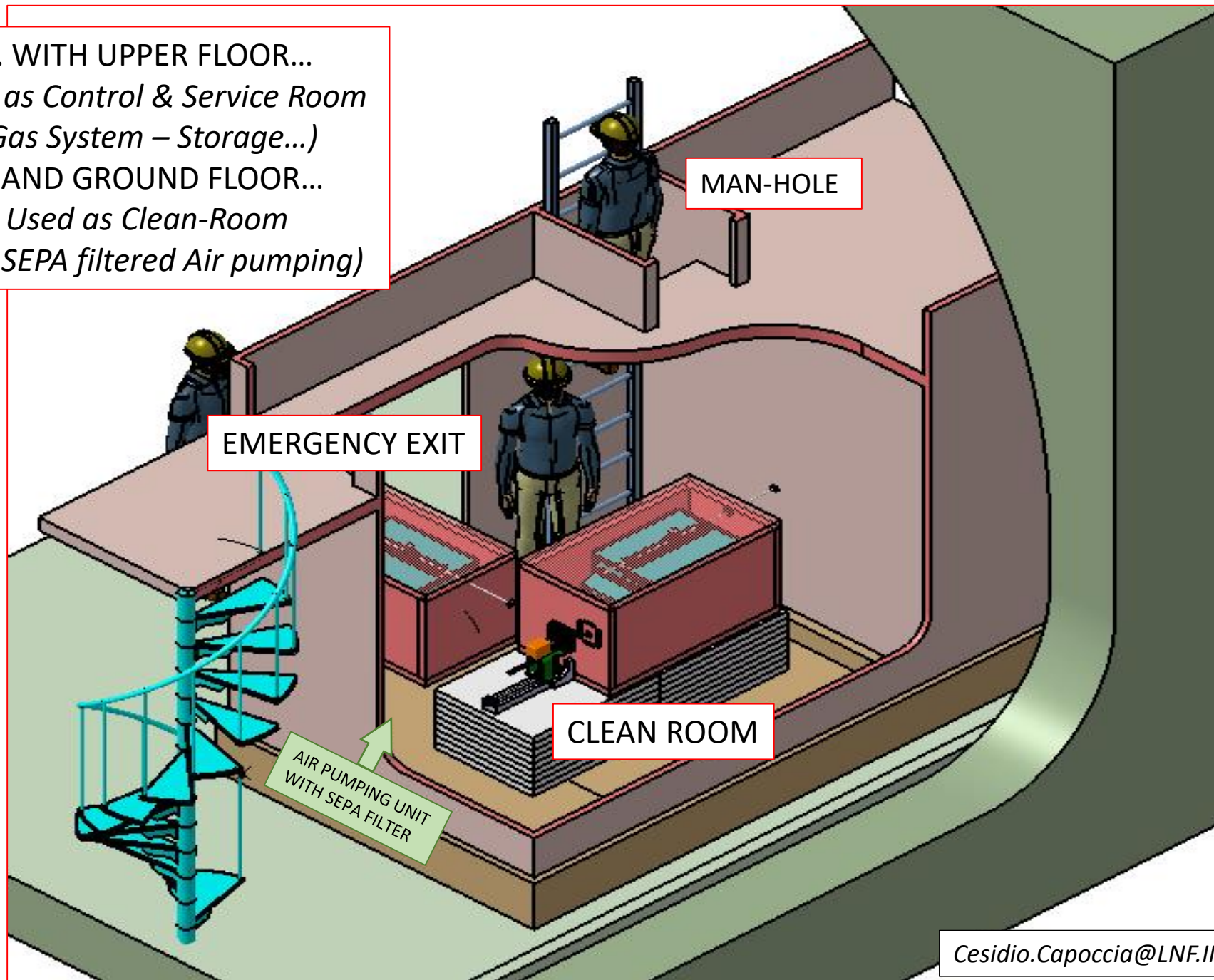

WATER-SHIELDING... NOT EASY !!

(PROBLEM WITH SPACE & HANDLING)

WATER SHIELDING DONE WITH
MRP-TANKS & POLYETHYLENE PARTS

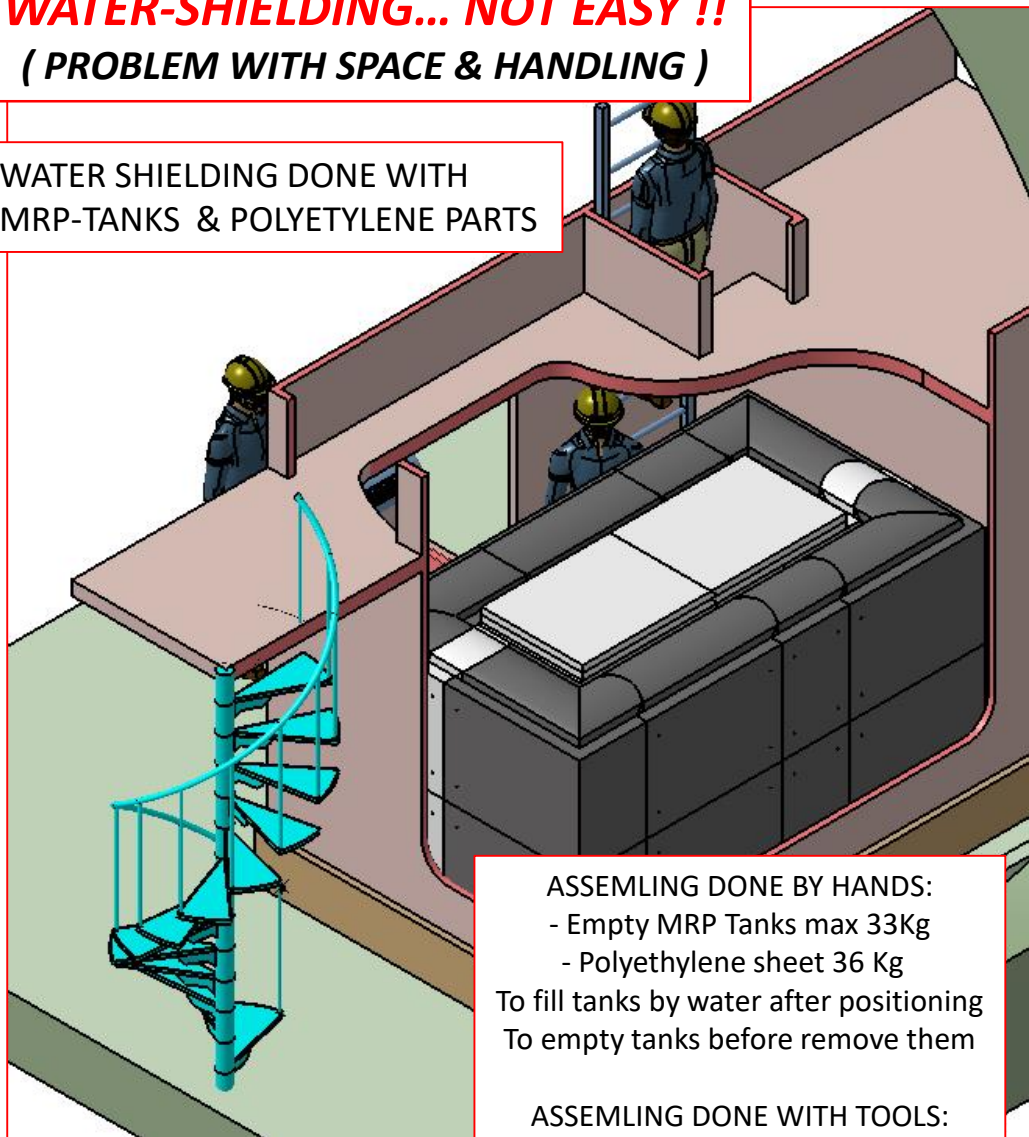

ASSEMBLING DONE BY HANDS:
- Empty MRP Tanks max 33Kg
- Polyethylene sheet 36 Kg
To fill tanks by water after positioning
To empty tanks before remove them

ASSEMBLING DONE WITH TOOLS:
- Polyethylene ¼-MRP-shape 90 Kg

N. 16 MRP-TANKS

N. 04 POLYETHYLENE BLOCK (1/4 MRP SHAPE)

N. 36 POLY. SHEETS 950x750x50 (BOTTOM & TOP)



Cesidio.Capoccia@LNF.INFN.IT

WATER SHIELDING WITH
MRP-TANKS &
POLYETHYLENE PARTS

POLYETHYLENE PARTS

ASSEMBLING DONE BY HANDS:

- Empty MRP Tanks max 33Kg
- Polyethylene sheet 36 Kg

To fill tanks by water after positioning
To empty tanks before remove them

ASSEMBLING DONE WITH TOOLS:

- Polyethylene $\frac{1}{4}$ -MRP-shape 90 Kg

(* Necessary to have access)

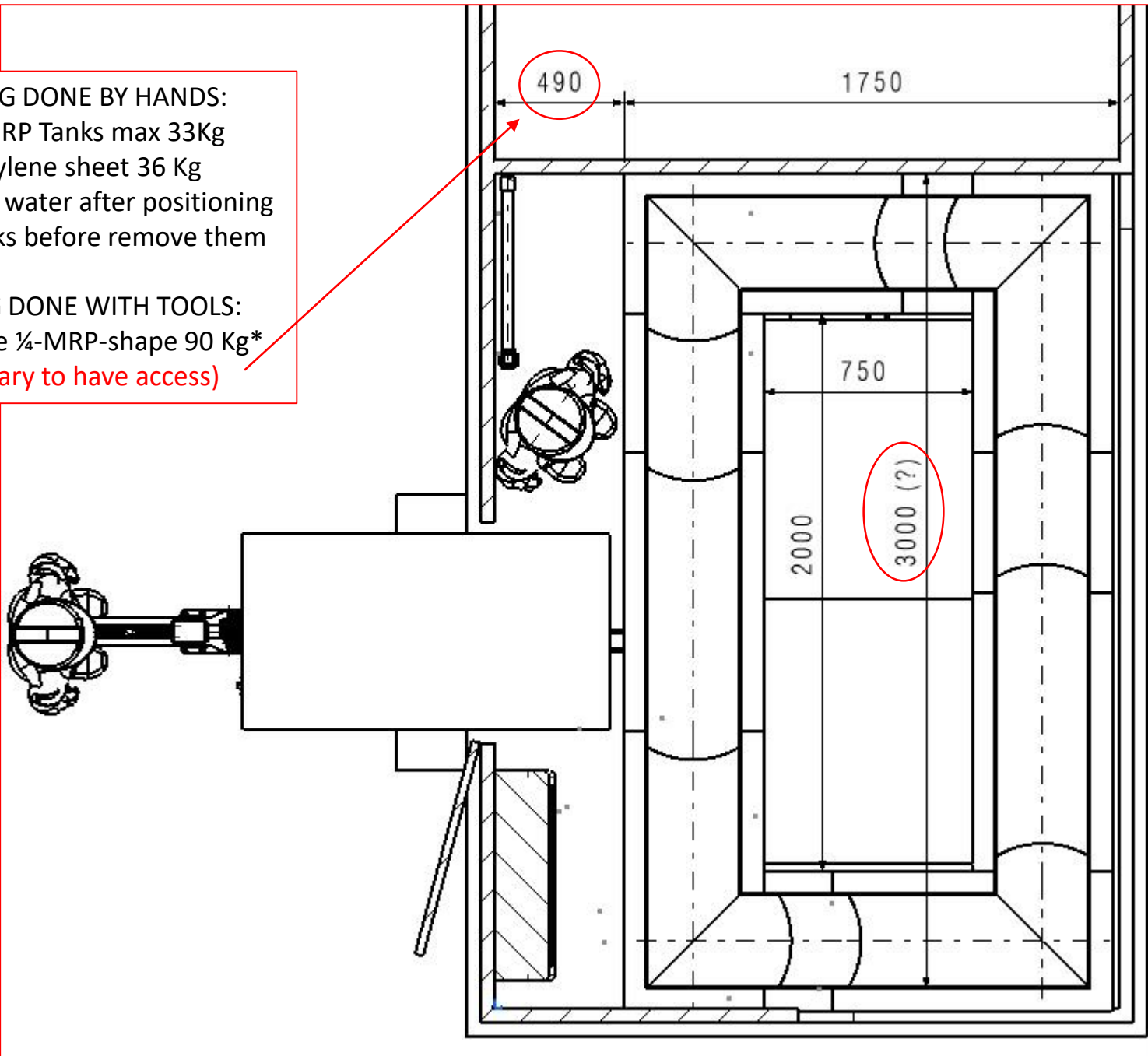

WATER-SHIELDING... NOT EASY !!
(PROBLEM WITH SPACE & HANDLING)

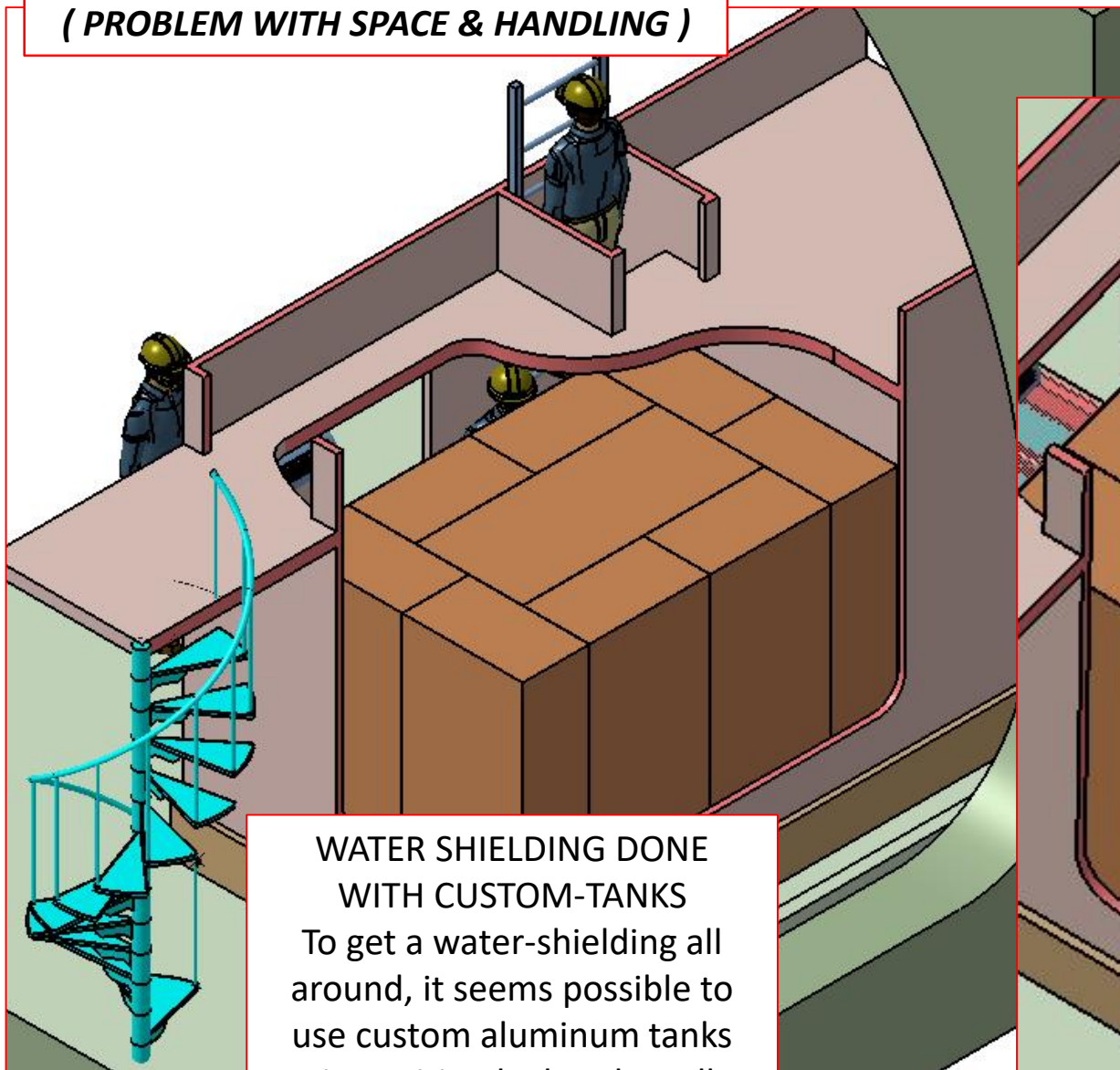

WATER SHIELDING DONE
WITH CUSTOM-TANKS
To get a water-shielding all
around, it seems possible to
use custom aluminum tanks
set in position by hands-trolley.
(If aluminum can be used)



Cesidio.Capoccia@LNF.INFN.IT

WATER SHIELDING DONE WITH CUSTOM-TANKS

To get a water-shielding all around,
it seems possible to use custom aluminum tanks
set in position by hands-trolley.
(If aluminum can be used)

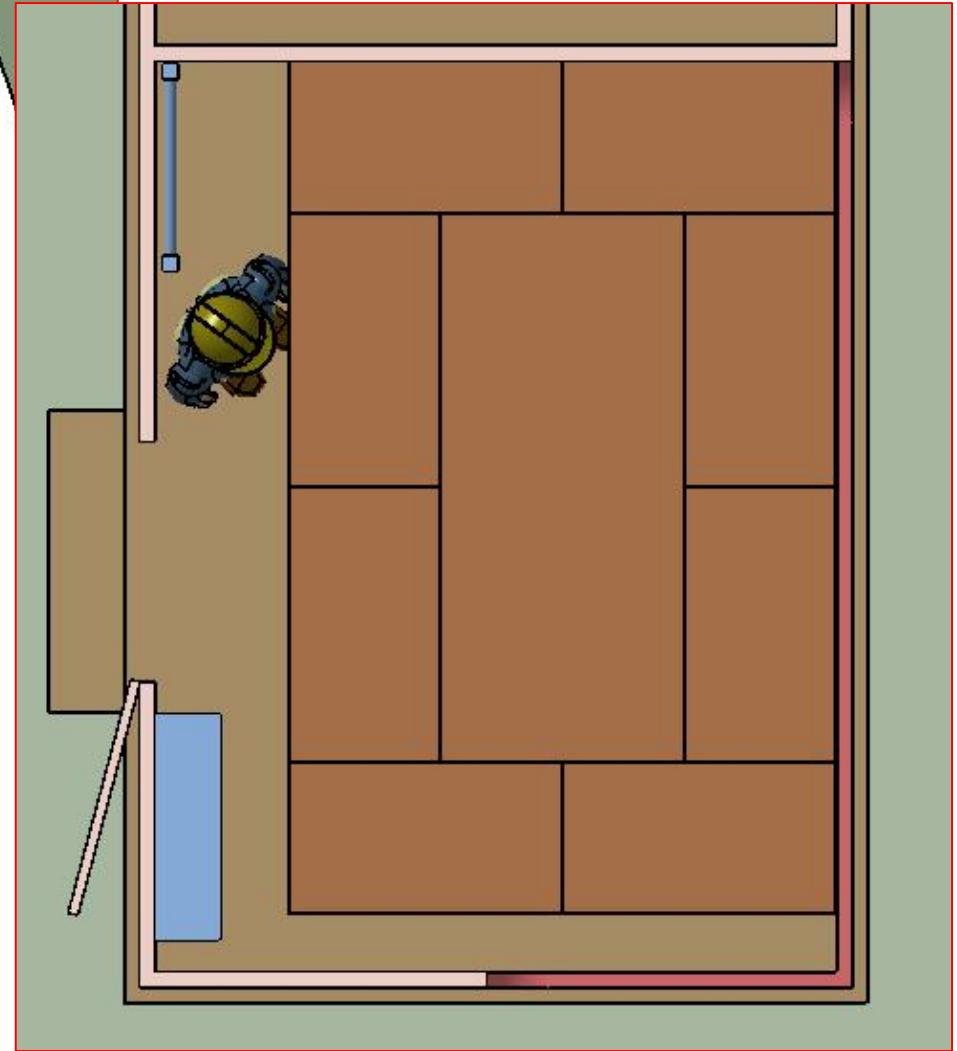
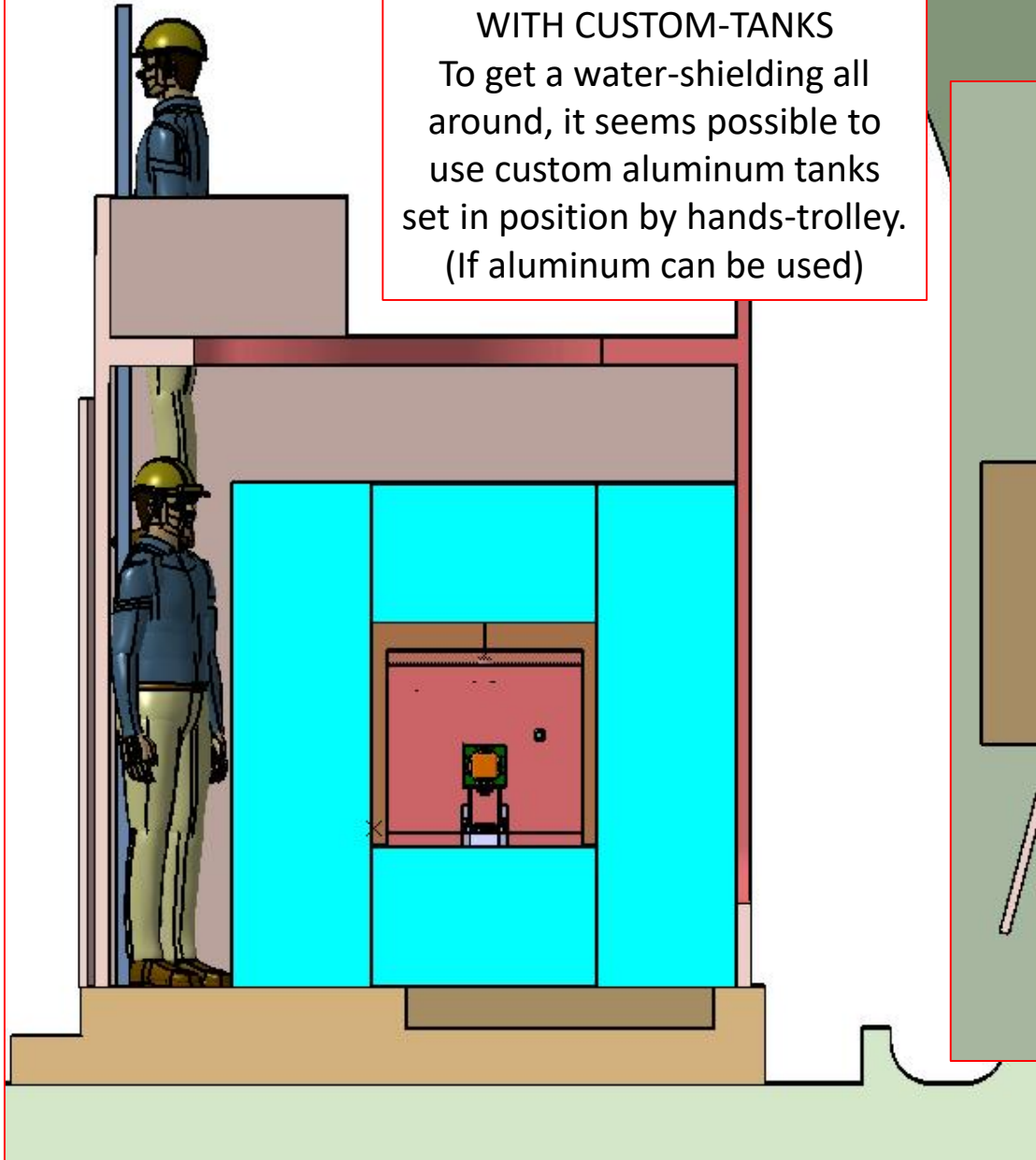

WATER SHIELDING DONE
WITH CUSTOM-TANKS
INSTALLATION STEPS...

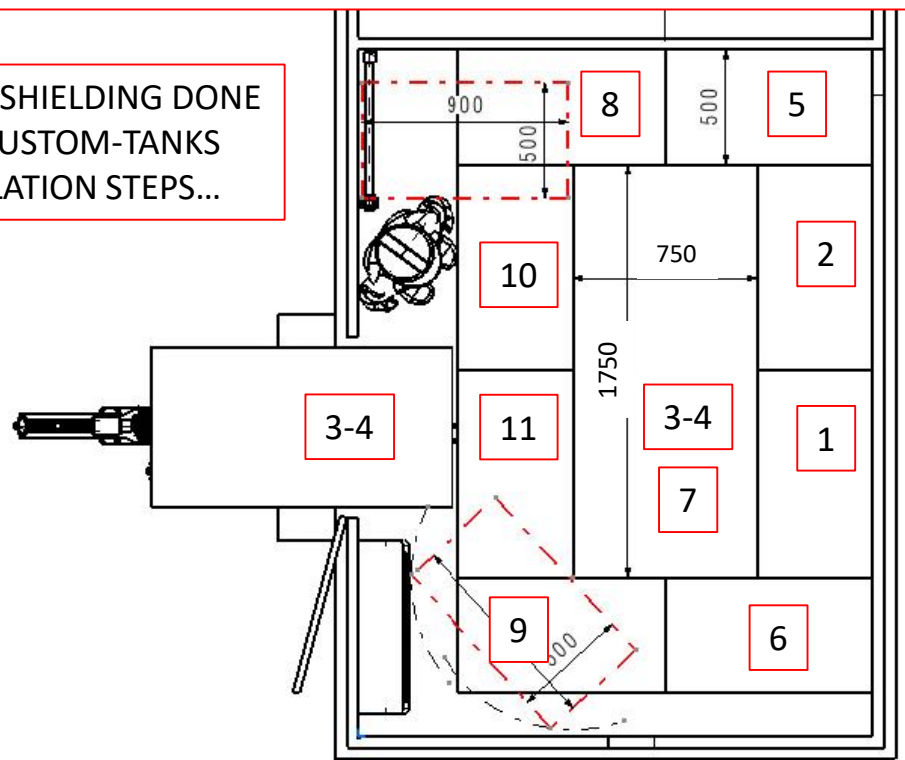

From 1 to 4 -> Complete access to detector
From 5 to 6 -> Limited access to detector
From 7 to 11 -> Any access to detector

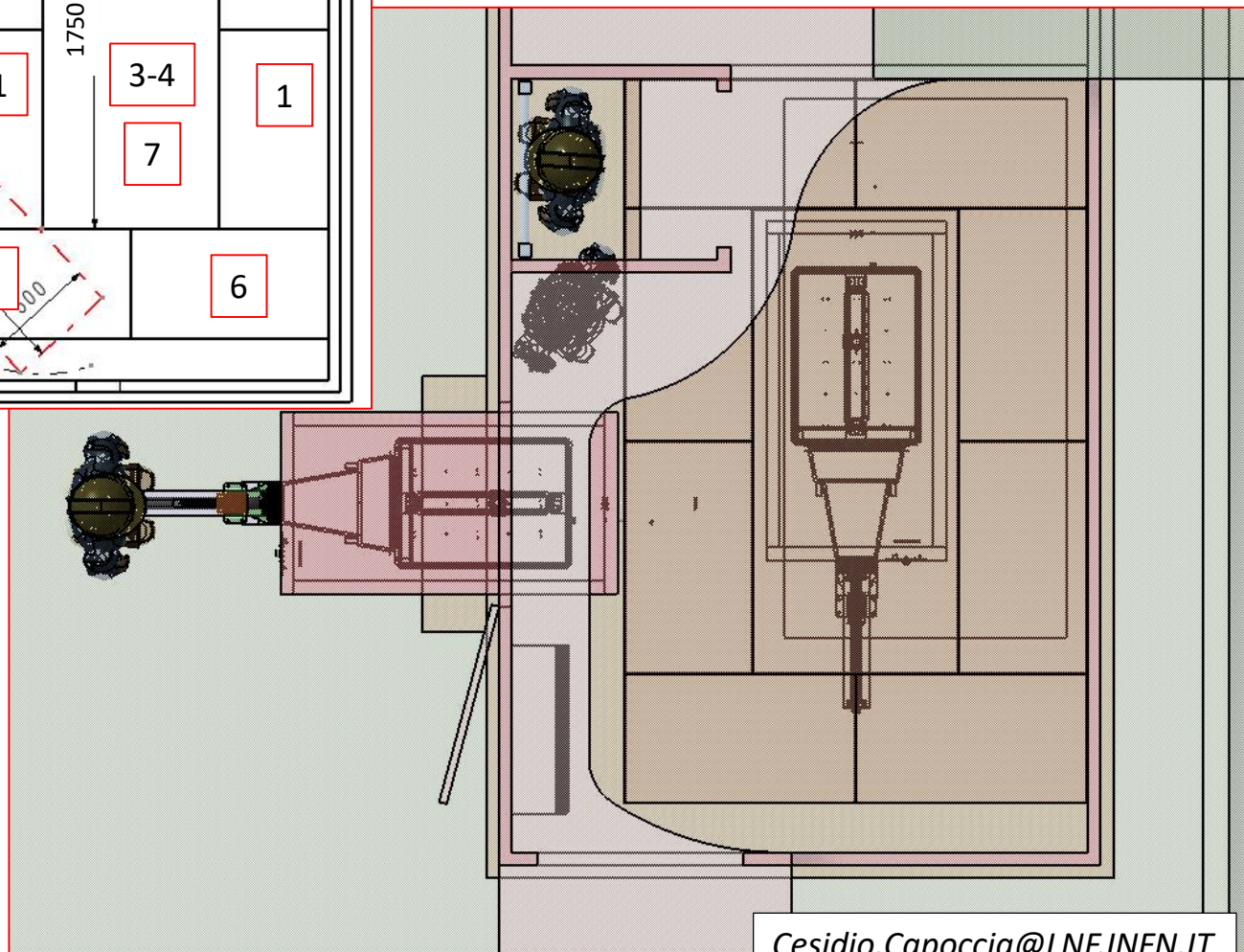

Cesidio.Capoccia@LNF.INFN.IT

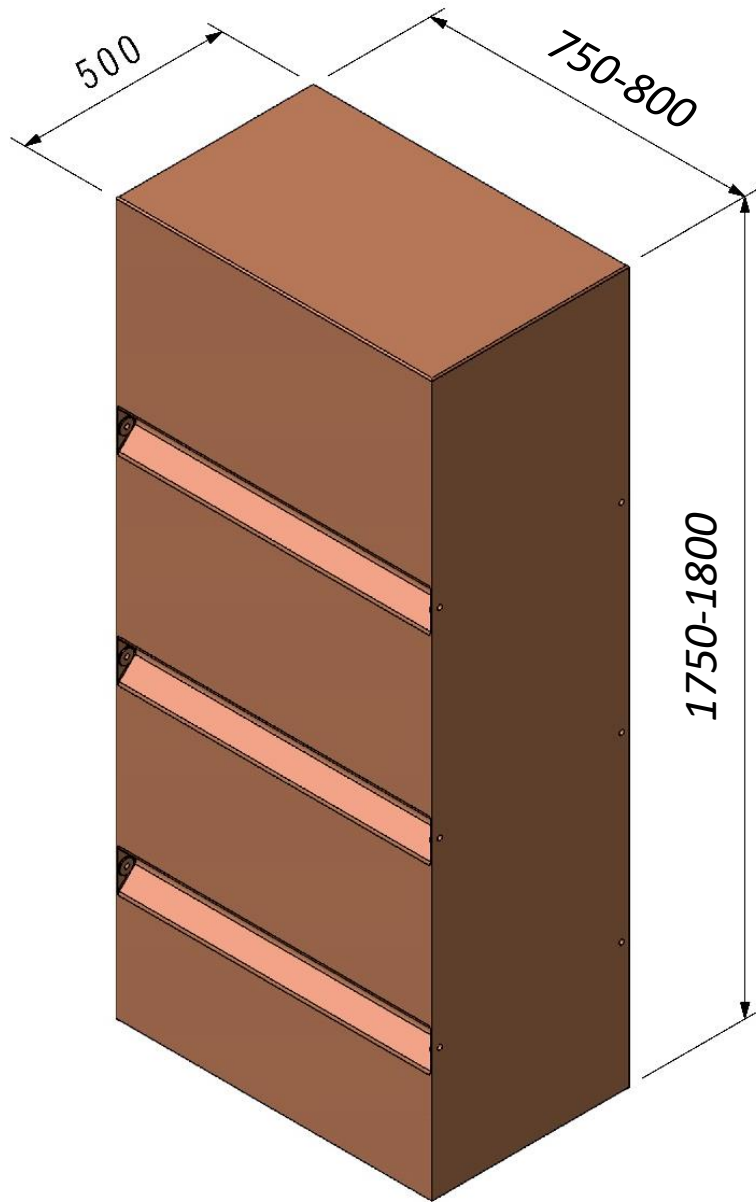

(TOWER) CUSTOM TANK

N.08 VERTICAL TANK

Material:

Made by Aluminum = 60 Kg

Made by Copper = 170 Kg

Made by Polyethylene (?)

N. 02 HORIZONTAL TANK

More or Less the same,
just mechanical structure
will be a little bit different

VOLUME: 800 Lt of Water